

Hi-Tech Garbage Chute System for Commercial & Residential buildings

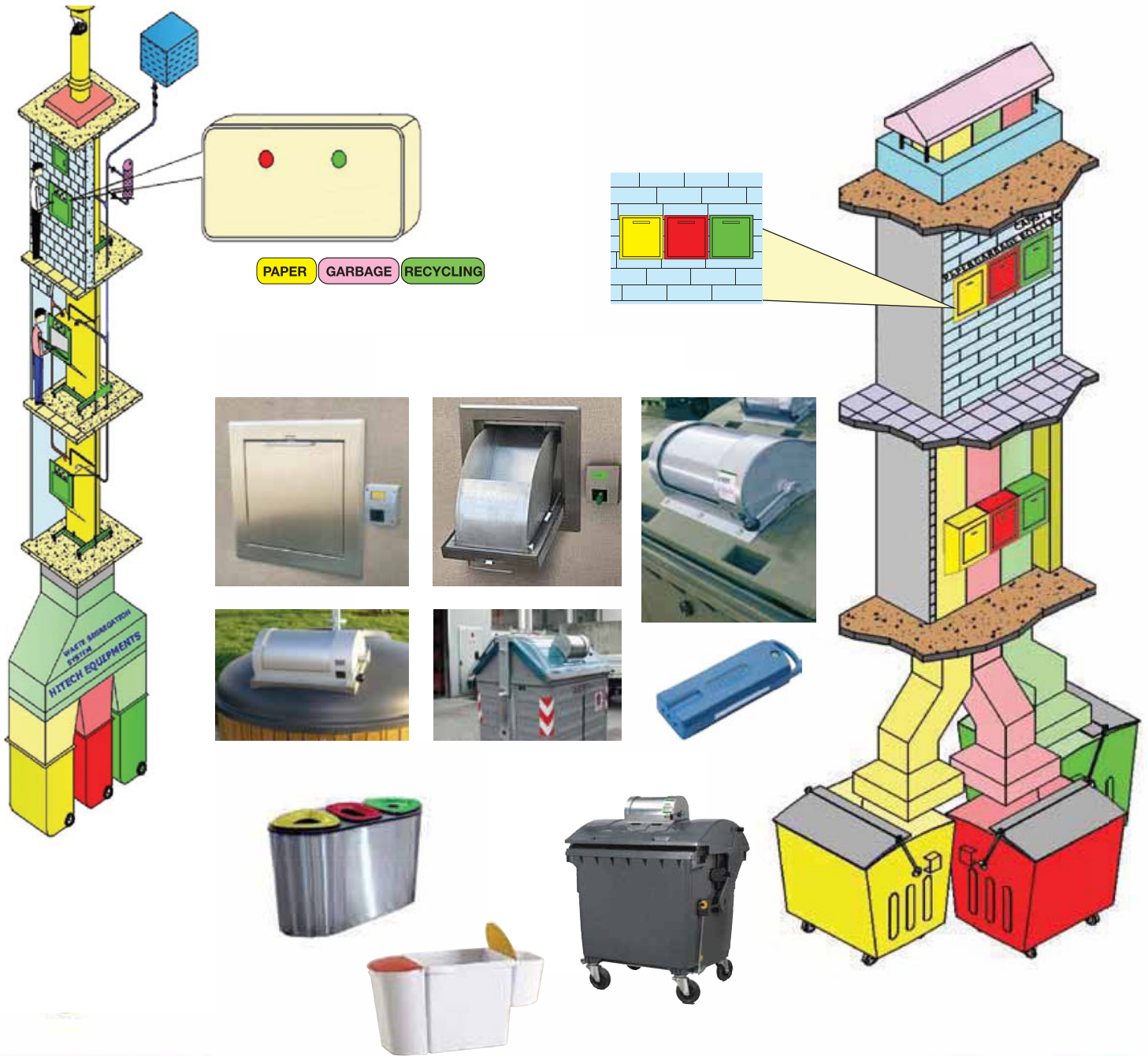

OUR BUSINESS SEGMENTS



Hi-Tech Equipments L.L.C. is a leading Manufacturer of waste disposal systems. We offer complete waste disposal solutions including waste segregation system. We support & comply with the concept of green building and sustainable design regulations. We are keen to improve environmental image and reduce cost of handling generated waste by homes, hotels industries and shopping malls.

Having been present in the U.A.E. for several years and focused on technical innovation, we have achieved expertise in the field of manufacturing Garbage Chute System.

We design, fabricate, supply and install complete garbage chute system for multistory commercial and residential buildings/complexes, hotels, shopping malls etc. We have completed many prestigious projects in U.A.E.

Our technology partners for Garbage disposal system : M/S. OSEREMEIER GMBH Germany.

Our Product Range

- ❖ **Waste disposal system (garbage chute system)**
- ❖ **Waste Compactor, Shredder, Crusher**
- ❖ **Linen Chute for hotels, furnished apartments & hospitals**
- ❖ **Debris Chute for construction site**
- ❖ **Waste Bins , Garbage trolleys**
- ❖ **Green Power , Solar energy**
- ❖ **Solar water heater**
- ❖ **Heat Pumps for swimming pools & domestic water heating and cooling**

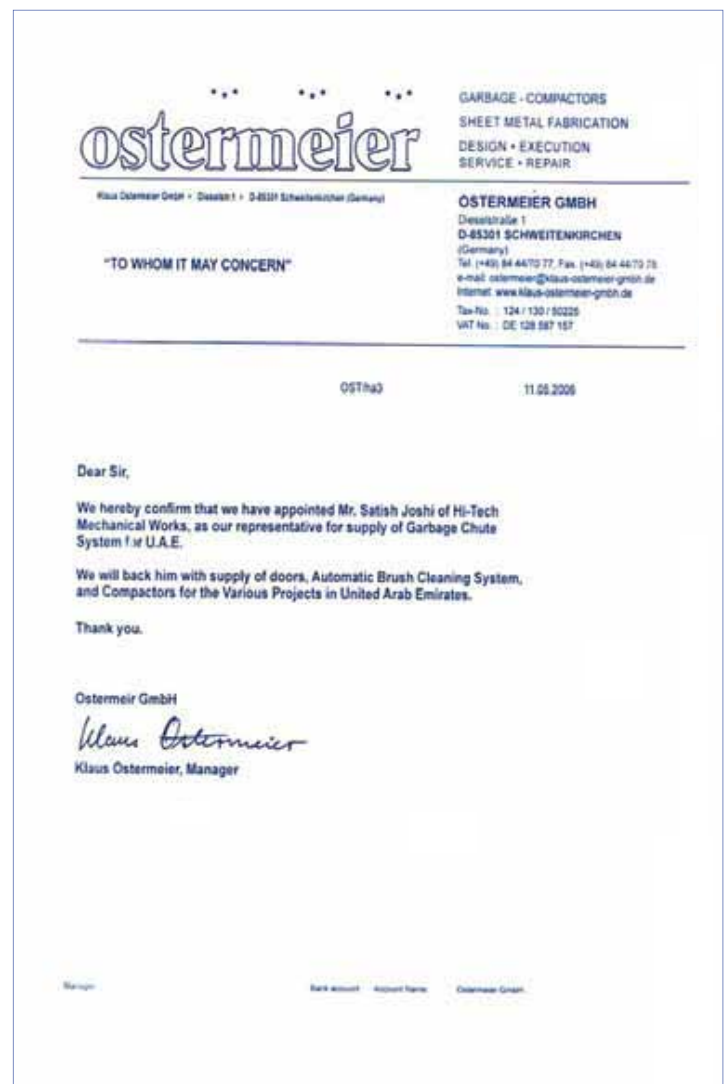

HI-TECH EQUIPMENTS GARBAGE CHUTE SYSTEM

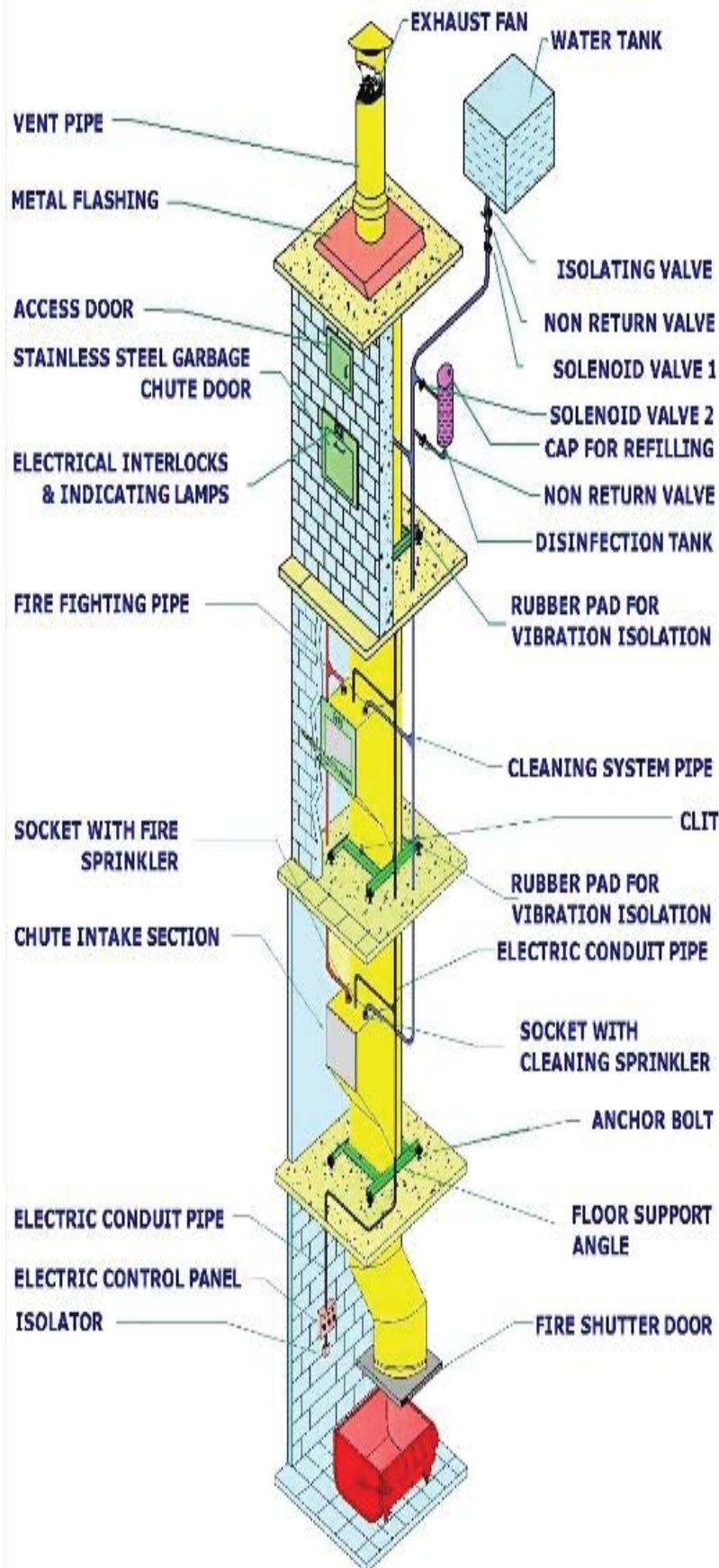

Urban Civilization & fast growing cities are forcing to construct Hi-rise residential and commercial buildings, complexes. In this changing scenario, the garbage collection from every floor & its disposal has become a tedious job. **Hi-Tech Equipments** garbage chutes are the means to overcome the above problem with ease & utmost hygiene.

Application Garbage chutes

Chute can be fitted in Commercial, Residential buildings, shopping malls, ships, luxury liners, oil platform, maritime and offshore industry.

Advantages of Garbage Chutes

1. Helps to collect total waste collection of the premises at one single point.
2. Waste disposal with ease & utmost hygiene.
3. Reduces power consumption of elevator.
4. Paper, Plastics, metal, food waste can be separated and recycled.
5. Reduces manpower.

Specifications of waste disposal system:

Our system is designed, manufactured and installed as per our technology partner **OSTERMEIER GMBH GERMANY** complying with VDI 2162, Bs1703: 2005, NFPA 82.

Material: Stainless steel S.S. 304, S.S 430 grade, thickness 1.2 mm, 1.5 mm, 2.0 mm.

Chute Diameter: 380mm, 450mm, 600 mm, 700 mm, 750 mm other diameter are optional.

Optimum shape: Round shape to ensure smooth unobstructed garbage free fall and self cleaning effect, however square or rectangular Section with small corner radius is available **optionally**.

Chute Fabrication: Chute tube is cylindrical; the longitudinal welds are produced full-length to ensure a smooth, water tight seam. The complete interior surface of the chute is absolutely smooth with no irregularities to prevent any waste being trapped. The joints are interfaced to overlap 5 cm in the downward direction.

Intake Opening: It is called as intake throat. Our low impact sloping throat and perfect depth of throat gives smooth fall to garbage bag and prevents dust from passing through the opening due to the flow of rising air. **Each floor will have 1 no intake opening.**

Intake Hopper (Door): **Material S.S. grade S.S.304**, polished to no 4 brush finish, top opening bottom hinged, self closing, hopper can be interlocked with "one user at a time concept" or locked only at the time of cleaning. **Outer frame size 550 x750 mm.** Each floor will have 1 no intake door.

Chute Mounting Frames (floor frame): We fabricate chute mounting frames from **50 X 50 x 5 mm M.S GALVANISED STEEL ANGLE** to support chute weight equally on each floor, these frames are anchor fastened with floor, we provide between the mounting frame and structure 4 pieces of rubber pad as vibration dampers to prevent the transmission of material-borne noise.

Adaptors:

Adaptors used to compensate for floor height differences; adaptors are available in lengths of 25, 50 and 70 mm. They are mounted on the bottom spigot end and bolted to the top and bottom pipe ring with the telescopic joint.



Sprinkler for fire fighting



Access Door

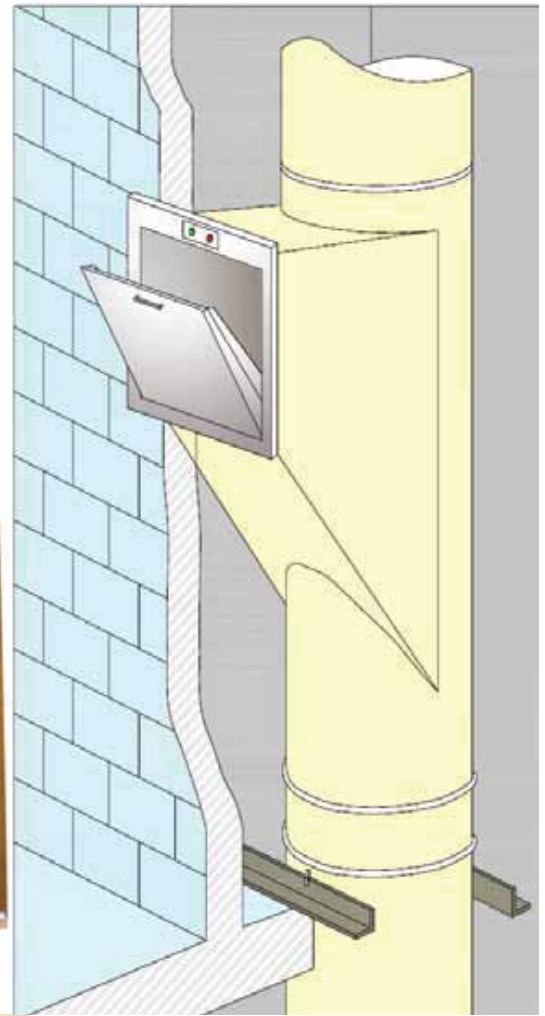

Intake Door in Open



Intake Door



Discharge Door (Spring Loaded Fire Damper) Fig 1.

Horizontal direction type discharge door is most commonly used when discharging directly in to compactor or container. The damper has a 1^{1/2} Hour ULC Label and it held open on 72⁰ C spring loaded Fusible Link Assembly: In case of fire fusible link melts and fire door closes the upward path of the chute. This door is intended only to provide smoke and fire protection to the chute riser.

D	613mm	562mm	510mm
A	679mm	657mm	608mm
B	740mm	756mm	655mm

Standard discharge door (Fig 2.)

This door is mounted with wheel on slightly inclined steel frame and fitted with fusible solder link at one end and other end is fixed through spring, in case of fire, fusible link will melt thus releasing door to close end of duct because of spring and inclined surface. Fire will not pass from garbage room to various floors in building.

Air Vent, fan

Vent is extended about 1.5 to 2.0 Meter above roof, fan is fixed either in the chute cover in a fan housing above the head of the chute or in a vent fixture in the roof. To ensure continuous ventilation and removal of smell, gases above roof level. Fan air handling capacity is selected to permit roughly 20 changes of air per hour. Generally Nominal diameter for these fans is 250 mm, and for high rise Tower 300 mm.



STANDARD VENT WITH FAN

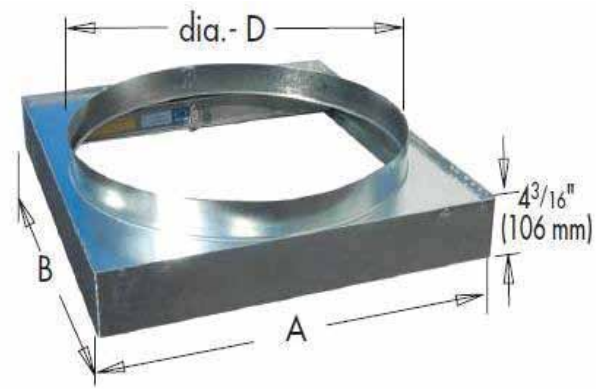

(2)

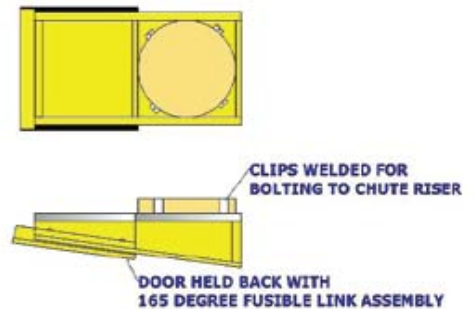

Chute Cleaning System:

We provide Spray Head at every intake throat which is connected by pipes to main water tank to clean the chute inside surface and door inside surface, cleaning operation starts from control panel mounted in the ground floor main garbage room. All doors are automatically locked during cleaning operation.

Disinfecting system:

This system is designed for use together with the manual or automatic (electric) wash spray system to spray disinfectant inside the chute or we can inject disinfectant in the incoming waterline so that it will mix and give good cleaning effect. A 5 liter tank is fixed for facilitated filling with disinfectant or deodorant solution. Our disinfectant system is mounted on the top of the chute or above top floor intake door. Access door is FIXED to have restricted access for filling of tank.

Automatic Brush Cleaning System:

This system is designed to clean the chute tube over its full length. Device comprises a cylindrical piece embedded with very stiff nylon brush which is automatically lowered and returned to their original position by an electric drive motor through control panel with UP / DOWN switch. By movement of the brushes in a chute duct it cleans the inside surface of the Chute tube. The water supply is switched on to clean the inside surface of the chute. The electric motor is mounted on top of chute. We have provided Control panel with overload protection relay and individual Control gear.

Electric Power Requirements:

Motor rating: 0.25 kW, 1330 rpm, IP 65,
Line voltage: 220 V, 50 Hz,

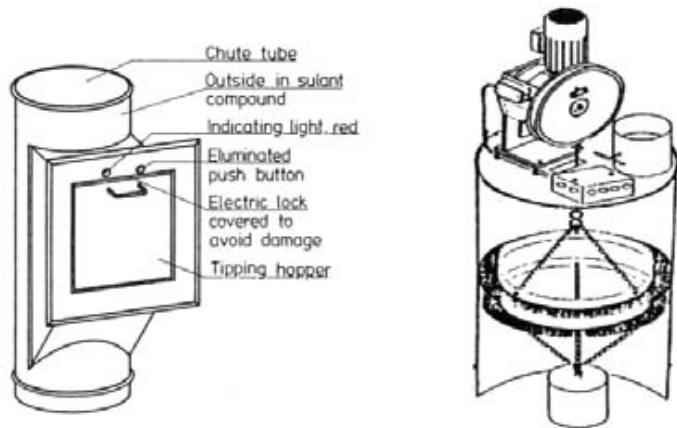

Noise insulation on outside circumference of Chute Introduction:

Any metal chute can become noisy under certain circumstances. A coating of noise insulate compound applied in fabrication Reduces the noise level considerably of falling bottles and cans up To 25dBA

Application:

The noise insulate coating is applied in the factory in a thickness of 1 – 2 mm. The complete external surface of the chute tube and throat fixture receives this coating. Noise insulate coating is fire rated "fire retardant". It has excellent weathering properties and can only be removed by the application of heat.

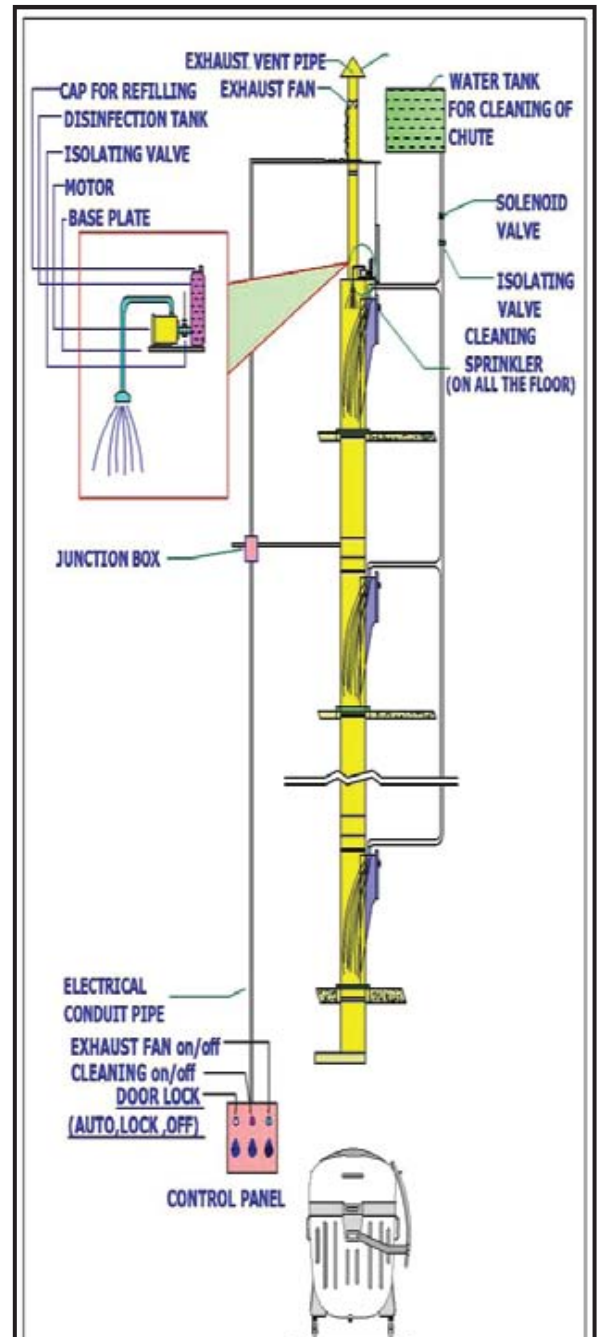

Refuse collection container Capacity 2.5 m3 With sliding lid according to DIN 30738

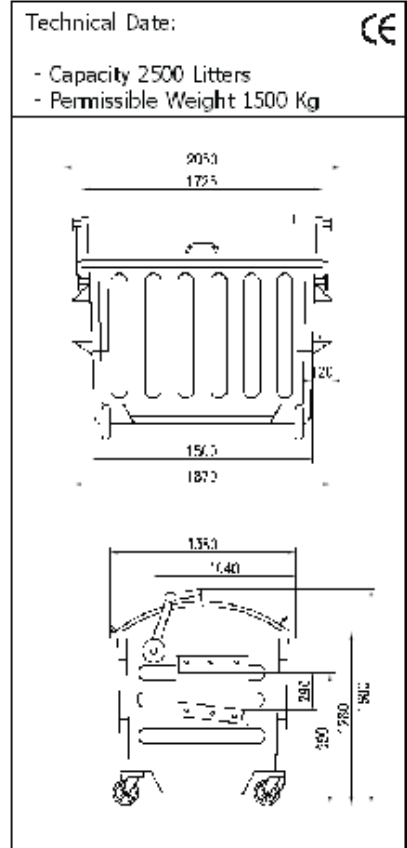

- **Body hot dip galvanized**
- **High stability provided by profile frame**
- **Spring tensioned hot dip galvanized sliding lid**
- **Continuous high quality welding seams**
- **Low steel sheet overlap**
- **2 Swivel wheel 200 mm at the rear**
- **2 Swivel wheel with breaks and steering lock at the front & Dimension all specification to suit Municipality Vehicle**

Refuse collection container with sliding lid according to DIN 30700

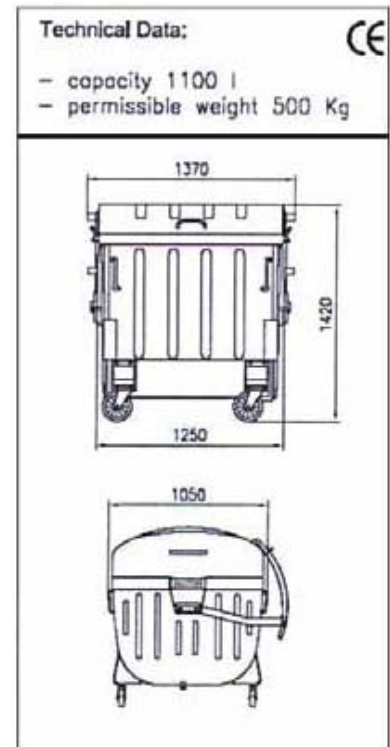

GARBAGE COMPACTOR HVC 600B

Hi-Tech garbage compactor HVC 600B is one of the smallest and most efficient compactors. This compactor is designed to be used in conjunction with a trash chute system. The operation is automatic, with the unit being activated by an electronic sensor, which senses trash in the loading hopper. These units are typically used with two or three cubic yard compaction containers which, when full are wheeled outside for pick-up by a commercial trash services provider. The system comes standard with full/fault indicator, overload protection, time out protection, PLC controlled panel with manual, auto and lock-out selections.

SPECIFICATION & TECHNICAL DETAILS

1	Operation: Automatic – Hydraulically Operated	10	Hydraulic Power: Pre-packed, Fully connected pack integrally mounted Normal operating : 1000 P.S.I. pressure
2	Operating Pressure: 40,000 Lbs	11	Motor:5.5 H.P TEFV Class F Insulation
3	Compaction: Compacts Waste to 20% of Original Volume	12	Pump: pressure balanced external gear type
4	Packaging: Directly into container	13	pump rate: 9.3 liter/min.
5	Application: Refuse Chute Feed	14	Oil reservoir : 40 liters
6	Capacity: 750 kg/hr. (13.7.M3/Hour)	15	Control Valves: 4 way
7	Compaction Chamber : 0.20m3 Capacity	16	Electrical Controls: Housed in keyed access
8	Machine Cycle: 40 seconds time	17	electrical Supply: 380 Volts, 3 Ph , 15A, 50HZ
9	Compactor Body: 8mm Thick	18	Other features- Automatic disinfectant spray- Repeat hammer action and Automatic Shut off

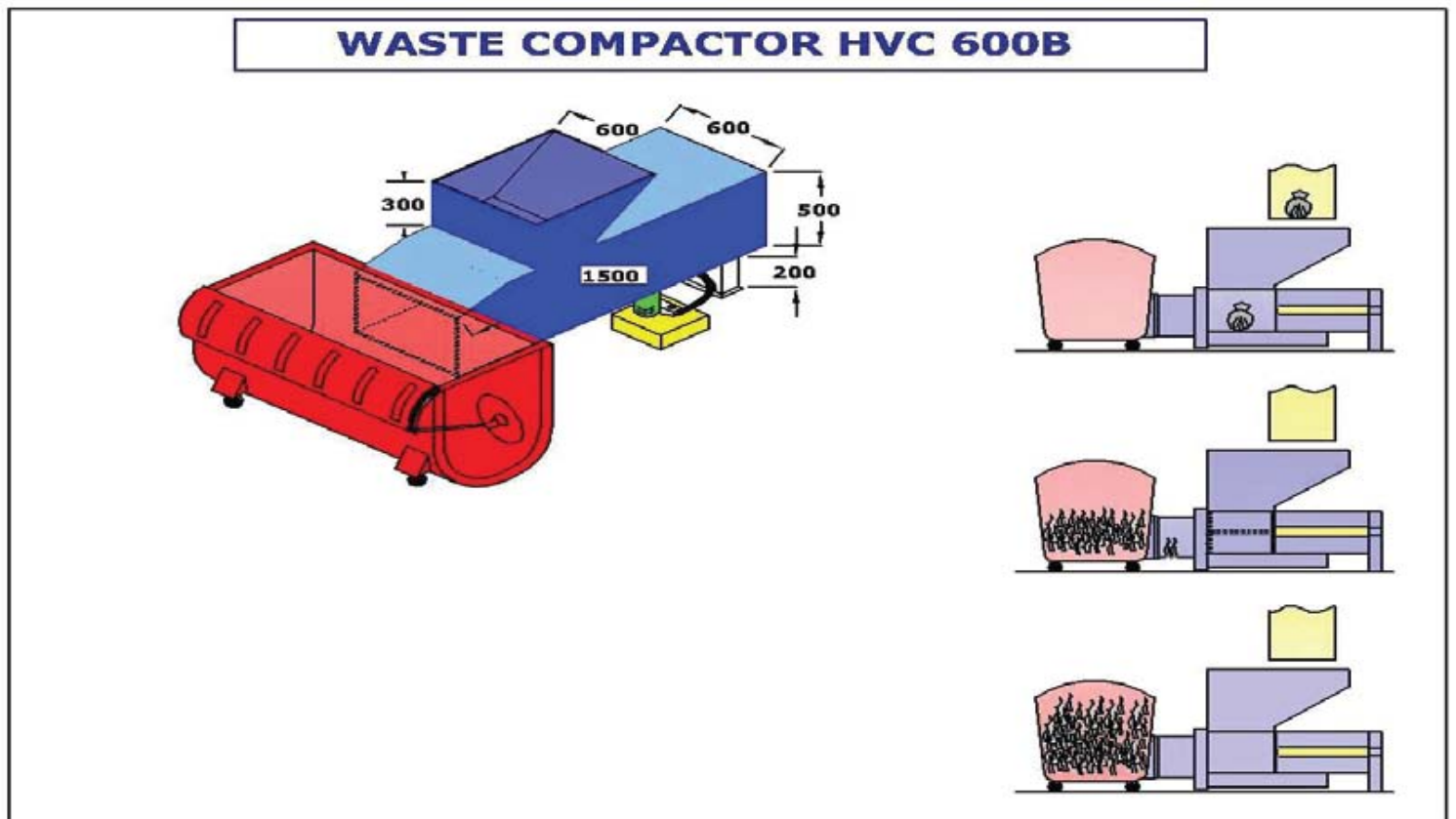

HI-TECH CONTAINERS FOR SEGREGATION OF WASTE .



Model : HT001
Measurement : H244 x W330 x D340mm

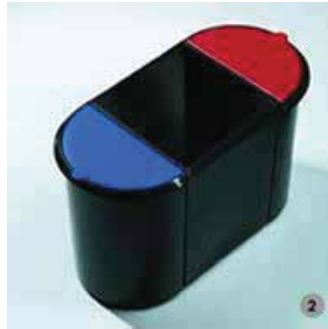

Model : HT002
Measurement : H350 x W280 x D555mm



Model : HT003
Measurement : H350 x W460 x D480mm



Model : HT006
Measurement : H 760 x D 295mm



Model : HT007
Measurement : H 760 x D 295mm



Model : HT008
Measurement : H 610 x D 295mm

Ashtray Waste Bin



Model : HT009
Measurement : H 490 XW 250 x D 250 mm



Model : HT010
Measurement : H 720 XW 270 x D 270mm



Model : HT011
Measurement : H 720 XW 270 X D250mm



HT - Bermuda Triple
Model : HT012
Measurement : H 788 XW 1145 xD450mm



HT- Bermuda Double
Model : HT013
Measurement :H 790 XW 850 x D 450mm



Model : HT014
Measurement : H 740 XW 300 x D 300mm



Hi-Tech Equipments

Container - Packer HT 1100

Waste-compactor for 1,1m³ bins saves space and money



In order to prevent the rolls from damages, the compactor - base lifts the contact to the floor while compacting



- Compact your waste and recyclables
- The costs will be reduced through volume - reduction
- Needless containers -save space
- Use valuable space in your building for better functions



Hi-Tech Equipments L.L.C.

Tel : +971 4 2676440, Fax : +971 4 2676450, Mob : +971 50 6950649
P.O. Box: 19427, Dubai, U.A.E, E-mail: joshisg@eim.ae, hitechet@eim.ae

Container - Packer HT 1100

Deflate the air out of your waste

Waste and recyclable waste can be filled in the normal 1.1m³ bins and compacted by a pivoting compaction plate. The volume can be reduced up to 1:3

As quantity of waste and costs are constantly rising, the unit is cutting both: quantity and costs



The compactor can be used in and outside. When the container is full, Open the lid of the container and push the container onto the platform of the compactor. The compaction plate must be lifted. There is enough space for filling in. the compaction plate manually operated with two hands compacts inside the bin. It is absolutely full as soon as there is no more space for filling in more. The container will be lifted in order to protect the rolls. Possible also for other bins like 770 liter bins or 2.5m³ as a special design
Operation of compactor is with two hands. One for the switch for three-motor and one for the hydraulic lever.

Technical Data

Motor	Total weight	Electric connection	Stroke	Pressure	Compaction Plate	Dimension over all
1 KW	245 kg	220 Volt	Curved	3.200 KN	1.000 x 630	1.980 x 1.200 x 1.250 H x W X D



Hi-Tech Equipments L.L.C.

Tel : +971 4 2676440, Fax : +971 4 2676450, Mob : +971 50 6950649
P.O. Box: 19427, Dubai, U.A.E, E-mail: joshisg@eim.ae, hitechet@eim.ae

Linen Chute System

A Linen Chute or Laundry Chute is used in hotels and hospitals for transporting laundry to a lower common level for cleaning. Our chutes meet all NFPA-82 National Standard codes and the intake doors are fire rated.

Chute Material

Stainless steel Grade 304 thickness 1.5 mm, 2.0 mm

Intake Doors

Typical 450 x 600 mm hand operated intake doors, self closing, self latching, noiseless, side hinged 170° swing with 1-1/2 hour fire rated. Entire door (front and back panels) in stainless steel brush finishes with lock and Keys.

Discharge

For built in wall discharge of hopper type, a self closing, top hinged, 165° F fusible link; for direct discharge into receptacle use standard trash chute discharge.

Vent

300 mm diameter vent of same gauge as chute. Extending minimum of 1 meter (per NFPA) above roof with metal safety cap.

Floor Frames

Standard floor frames are 50 x 50 mm x 5mm steel angle 300mm longer than the chute diameter

Standard Accessories

1/2" BSPT flushing heads above top intake. Additional 1/2" fire sprinkler heads at alternate intakes and at first intake as required by NFPA code.

Chute Construction

Chutes is fully factory assembled with all joints welded. There shall be a minimum of one expansion joint per floor and a flush interior assembled without bolts, rivets or clips. The intake door and frame shall be adjustable and securely fastened to the intake throats which forms as an integral part of the chute section. Chute throat shall have a standard dimension 250 mm depth. Larger throats built to accommodate special job conditions. Chute shall be straight and plumb with no offset.

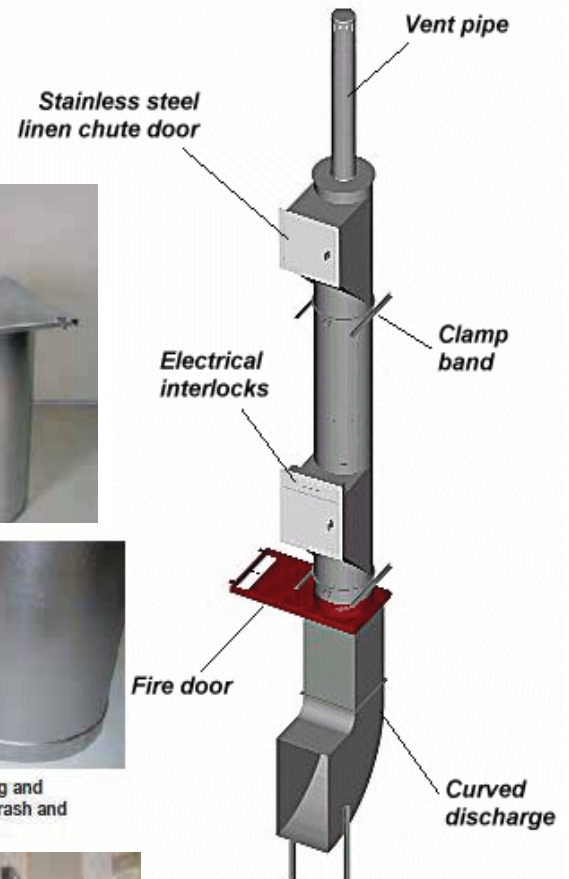

Optional Disinfecting and Sanitizing Unit for Trash and Linen Chutes



Linen Discharge



Intake Door Sizes*	
Chute ø	Width x Height
600mm	450 x 450mm
700mm	500 x 500 mm
750mm	550 x 550 mm
900mm	600 x 600mm



Hi-Tech Equipments L.L.C.

Tel : +971 4 2676440, Fax : +971 4 2676450, Mob : +971 50 6950649

P.O. Box: 19427, Dubai, U.A.E, E-mail: joshisg@eim.ae, hitechet@eim.ae

LINEN CHUTE

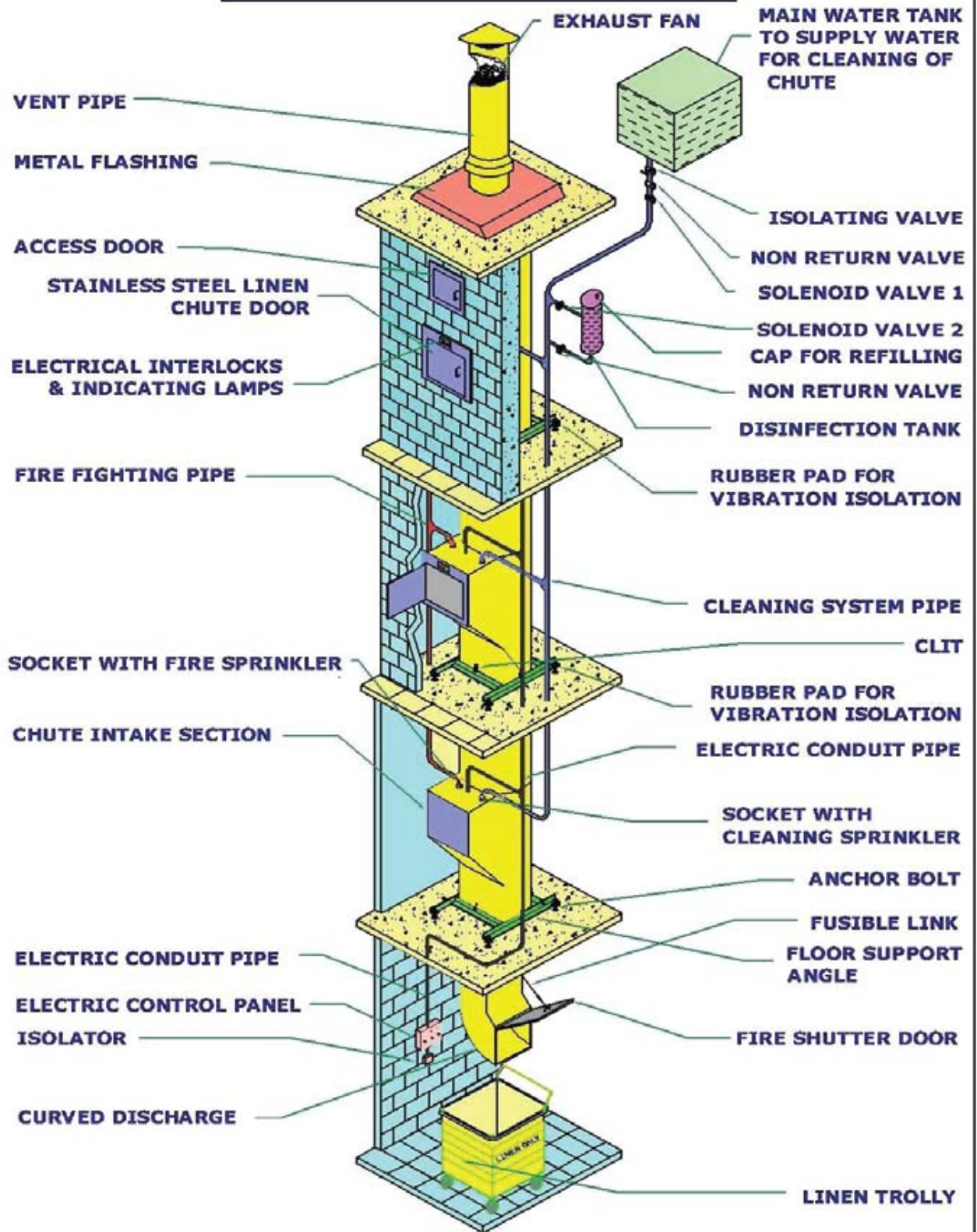

Hi-Tech

Hi-Tech Equipments L.L.C.

Tel : +971 4 2676440, Fax : +971 4 2676450, Mob : +971 50 6950649

P.O. Box: 19427, Dubai, U.A.E, E-mail: joshisg@eim.ae, hitechet@eim.ae

Hi-Tech Equipments L.L.C

PARTIAL LIST OF PROJECTS - GARBAGE CHUTE SYSTEM

S.No	Project	Contractor	Consultant
1	G+5 & G+8 Harvard Medical School Dubai – Dubai Health Care City,	Al Naboodah Contracting Company	Arif & Bintoak Consultant Architects & Engineers
2	G+4 bldg at Baraha, Dubai	Al Naboodah Contracting Co.	Adam Bureau for Design
3	4 no - G+5 Building for Dubai Festival City	Al Naboodah Contracting	Khatib & Alami Consolidated Engineering Company
4	3B+G+18 Floor Residential Building Ms.005 Imp2 Dubai	ANC Contracting LLC	BDPL Gulf Architects & Consultants
5	3B+G+7 Res Building No Plot 317-532 Block Al Mankhool (Sheraton hotel at Bur Dubai)	ANC Contracting LLC	ARENCO
6	3B+G+23+PENTHOUSE OFFICE & COMMERCIAL DEVELOPMENT, at Business Bay, (BILHAB TOWER)	ANC Contracting LLC	Arkiteknik International Consulting Engineers
7	(B+G+6+R) ACSS Office Building, On Plot No. DOZ/31 Dubai Outsource Zone	United Engineering Contracting	Khatib & Alami Consolidated Engineering Company
8	3B+G+12+Health Club Building at Al Barsha First (Chelsea Hotel)	Al Mazrouei Bowyer Building LLC	Arif & Bintoak Consultant Architects & Engineers
9	4 NO - B+G+8 Floor Residential Building at Dubai, Silicon Oasis,	Saleh Construction	LACASA Architects & Engineering Consultant
10	5 NO - G+3 Story Staff Accommodation Building on Plot No.359-927 al Quoz For Government of Dubai	Bin Zayed Contracting LLC	ORION Engineering Consultant
11	G+M+5 Floors at Al Barsha (Centro Hotel)	Shapoorji Pallonji Mideast LLC	Nasser Engineering Services
12	G+3P+30 Floors Regal Tower – 2 at Business Bay Dubai	Al Rajhi Projects Contracting LLC	Khatib & Alami Consolidated Engineering Company
13	G+3P+27 Floors IRIS BAY Development @ Business Bay	Al Habtoor Engineering Enterprises	Ws Atkins Partners Overseas
14	4B+G +42+3 service floor on plot 392-296 at Dubai marina Trident Grand Residential Building	CSHK Dubai Contracting	RMJM Architects
15	3B+G+3P+18 +GYM floor Mayfair Residency – on plot BB.A06.047 and 3B+G+3P+17 +GYM Mayfair Tower on Plot BB.A06.049 for DEYAAR DEVELOPMENT at Business Bay, Dubai	Engineering Contracting Co LLC	Arab Expert Engineering Consultant
16	Linen chute for G+9 Floor -Aviation Club Hotel, Al Garhoud, Dubai At Plot No. B214 – 233	Al Rostamani Pegel LLC	RMJM Architects
17	Commercial & Residential Tower, 2B+G+29+Mech. Floor & 2B+G+1 on plot 392-445(5N), ORRA MARINA TOWER at MARSA Dubai for Global king Technology,	Shinsung Engineering & Construction Co Ltd	Al Hawraa Engineering Consultants
18	B+G+21 Floors Commercial & Residential Development On Plot No. 231-124 Al Nahda First, Dubai	Bin Belaila Contracting	Arkiteknik International Consulting Engineers
19	Commercial & Residential Development on plot no – 134 – 1039, At Al Mamzar Dubai	Eastern International Dubai	Arif & Bintoak Consulting Architects & Engineers
20	Office Building on Plot No 127-1908 At Hor al Anz Dubai	Eastern International Dubai	Khatib & Alami Consolidated Engineering Company
21	B+G+4 Hotel building (linen chute system) at Al Qusais (LAYIA hotel project)	A.B Building Contracting Co.	National Engineering bureau
22	2B+G+3P+HC+25 Typical floor on plot no BB.A02.011, Business Bay (Ontario tower)	A.B Building Contracting Co.	DARTIN engineering consultant
23	LINEN CHUTE SYSTEM For G+23 +roof and Garbage chute system for G+ 3 level for MAF hospitality, Pullman Hotel@ Mall of the Emirates Dubai U.A,E	KHANSHEB CIVIL ENGINEERING LLC Dubai	NORR Architects & Engineers
24	G+6+Roof level (Easy Hotel). At JAFZA DUBAI, for NAKHEEL.	KHANSHEB CIVIL ENGINEERING LLC , Dubai	ARCHCORP Architectural Engineering
25	3B+G+9 Level IBIS Hotel & Offices DM.P 124-255, Al Regga Road for MAF INVESTMENT Dubai	KHANSHEB CIVIL ENGINEERING LLC , Dubai	WS. Atkins & Partners Overseas

26	G+10 bldg for Majid Al Futtaim MAF Tower-2 @ Deira City Centre	KHANSHEB CIVIL ENGINEERING LLC , Dubai	Dar Consulting engineers
27	Waterfront, Al BADRAH Development Manara Distict Stage -1	Mammot Contracting Co LLC	WBME
			Engineering Consultants
28	G+20 & G+31 Marina Scape Development	Larsen & Toubro	Arch group
29	G+8 Bldg at Tecom	GINCO Contracting Co.	Archdome
30	G+2 Labour Accommodation bldg	Team Engg. Contracting Co.	Al Hashmi Consultants
31	G+13 Bldg at Tecom	GINCO Contracting Co.	Al Ajmi Consultant
32	G+7+R Al Kharbash Building at Bur Dubai	Sumer Contracting Co.	Al Suweidi Engineering Consultants Bureau
33	Residential Building B+Gr+12 Floors + Roof Plot No. 241-543 Al Nahda 2 . Dubai	Sumer Contracting L.L.C	Al Khawajah Engineering Consultancy
34	B+G+2+GYM at Al Qusais second for Mr. Saeed Hamad Musleh Al Ahbabi	Sumer Contracting LLC	Design Center Architects & Engineers
35	3B+G+6 Typical Floors Office Building on Plot No.373-430 For Al Barsha First For M/s Deyaar Development	Condor Building Contracting	LACASA Architects & Engineering Consultants
36	Makateb Office Building on Plot No's MB-0168 & MB-20 at IMPZ / P- 067H	Condor Building Contracting LLC	Arab Experts Engineering Consultants.
37	2B+G+7 Commercial Residential Building at AL Marsa .	Khorry Hill Contracting Company	Al Hashemi Planners, Architects, Engineers
38	2B+G+6 Commercial Residential Building On Plot No. 373-435 at AL BARSHA	Khorry Hill Contracting Company	Al Hashemi Planners, Architects, Engineers
39	G+M+7 Building at Dibba, Fujairah	Fujairah National Insurance Company	DRU Architects Consultant Interior Designers Graphic Designers
40	G + 15 + Healthcare Commercial Bldg. on Plot No. 8/5 At Alayam, Fujairah	Fujairah National Insurance Company	DRU Architects Consultant Interior Designers Graphic Designers
41	Commercial Residential Building Al Barsha First Plot No.373-1195 – Dubai	Solanki Contracting Co.	Al Burj Engineering Consultants
42	2B+G+6+R Floors Residential Building on Plot No. 373-425 at Al Barsha	Naresco Contracting LLC	Al Ajmi,Dubai Branch – Architects Planning Interior Design
43	G+6+HC+SP Residential Building Al Warqa'a First	Al Arif Contracting Co.	ARENCO (ABDULLAH AHMED ALMOOSA)
			Architecture & Engineering Consultants
44	Commercial & Residentail Building (2b + G + 11) at Dubai silicon Oasis	Yosuf & Aman Contracting	National Engineering Bureau
45	(3B+G+6) Commercial Building on plot No 321-193 at Al Mina Dubai	Lootah Contracting	Rice Perry Ellis ,Project Managers Planners Architect Engineers.
46	G+4 Comm. For AL REYAMI	Candian Contracting Company	National Engineering Bureau
47	B+G+7+2+R Residential Building On Plot No 124-612 Al Muraqqabat	Kap Al Muhairy & Al Rayes Contracting	Arab Experts Engineering Consultants
48	G+12 Bldg. on Plot 241-255 at Al Nahda	Safa Contracting Co.	Al Shurooq
49	S.S. Garbage Chute for G+4 Storey building	Tala Contracting Co	Abdulla & Associates
50	S.S. Garbage Chute System for Rafiq Mohd. Saeed G+4 Building	Al Ayali Contracting Co	Adnan Saffarini

51	S.S. Garbage chute system for G+M+4 storey building Al Plot 478 at Al Baraha	Bu Haleeba Contracting Co.	Civic Design
52	Garbage Chute System for G+M+4 Bldg on plot no. P-22 At Al Sabkha	Al Habbai Contracting	Style Consulting Engineers
53	Garbage Chute for G+M+13 Bldg for H.H. Sh. Abdul Rahma	Al Hamad Contracting	Al Nahda Engineers
54	Garbage Chute for G+M+9 Storey Bldg. Job no. 215 at Sharjah	Al Kharbash Contracting	Arab Eng. Bureau
55	Garbage chute system for G+4 Storey building for M.Ali Rashid Lootah at Al Baraha	Al Sumood Contracting Co.	M.AI Sh Mubarak
56	Garbage chute system for G+7 storey building on plot no. P-124 for Mr. Jasim Co Ahmad Abdul Rahman Al Rais	Al Hudaiba Contracting	Osman Audeh & Associates
57	Garbage chute system for G+7 storey bldg. at Al Khabesi for Mr. Sultan Bin Ahmad Nasir Lootah	S.S. Lootah Contracting Co.	Port Saeed Engineering
58	B+G+8 building at AL BARSHA FIRST , Dubai	Chirag Contracting Company	National Engineering bureau
59	G+3 bldg at Al Warqa'a Dubai	Al Abbar Contracting Co.	Zabeel Consulting Engineers
60	G+P+13+GYM at Al Barsha, Dubai	Ahmed Bin Dasmal Contracting	Pioneers of Expert Engg
61	Proposed Residential Building (G + 6) + GYM	Bhatia General Contraction Co	Civic Design Architects & engineers
62	Garbage Chute System for G+4 storey building for Mr. Mohd Bin Humaid Bin Dalmouk at Muragabad	Al Huda Contracting	Shadid Engineering
63	Garbage chute system for G+4 – Al Attar Shopping Complex	Ibrahim Lootha Contracting	Al Turath Consultant
64	Garbage chute system for G+4 bldg. at Al Baraha	M.A. Eassa Contracting Co.	Circle Consultant
65	Garbage chute for G+4 bldg. at Karama	Juma Ghanem Contracting	National Engineering Bureau
66	Garbage chute for G+4 bldg. at Hamriya	Al Khayat Contracting Co.	Dubai Consultant
67	Garbage chute system for G+4 building at al Baraha, Dubai	A Khayat Contracting Co.	Rokn Al Handasa
68	Garbage Chute for G+9 bldg. at Bur Dubai	Al Khayat Contracting Co.	F.A. Baker Consultant
69	G+3 building in Sharjah	Atco General Contracting Co.	Adnan Safarini
70	Garbage chute system for G+4 building at plot P-212 at Deira	Pan Gulf Construction Company	Abdulla & Associates
71	G+M+3 Commercial/ Residential Bldg at Naif, Deira, Dubai	Civil Construction Centre	Artica Architecture
72	G+10 Bldg. at Fujairah	Civil Construction Center	Talal Nawfal Engg Consultant
73	Garbage Chute System for G+4 Story Bldg. for Mr. Abdul Noor At al Baraha	Abu Hail Contracting Co.	Al Injaz Consulting Engineers.
74	G+7 Bldg. at Mankool, Bur Dubai	Al Tawhidi Contracting Co.	H.A.D.I. Eng. Consultants
75	Garbage chute system for G+4 bldg on plot P-155 at Marar Al Qadeem	Gulf Interstate Contracting	Adnan Safarini
76	Garbage chute system for G+4 Story Bldg. For Mr. Khalfan Bin Kharbash	Al Kharbash Contracting Co.	Development Consultant
77	Al Alawi office tower 2B+G+19 @ west bay area , Doha, Qatar.	Al Jaber Trading And Contracting Co. W.L.L. – Arabian Specialized Materials Co. L.L.C. – Doha – Qatar	Arab Engineering Bureau



Project : PULLMAN HOTEL@MALL OF THE EMIRATES,DUBAI
 Consultant : NORR ARCHITECTS & ENGINEERS
 Main Cont : KHANSAHEB CIVIL ENGINEERING LLC



Project : 3B+G+23+PENTHOUSE OFFICE & COMMERCIAL DEVELOPMENT
 Consultant : ARKITEKNIK INTERNATIONAL CONSULTING ENGINEERS
 Main Cont : ANC CONTRACTING LLC



Project : LINEN CHUTE SYSTEM G+10 FLOORS
 Consultant : R.M.J.M ARCHITECTS
 Main Cont : AL ROSTAMANI PEGEL LLC



Project : 2B+G+3P+HC+25 TYPICAL FLOOR – ONTARIO TOWER – BUSINESS BAY
 Consultant : DARTIN ENGINEERING CONSULTANT
 Main Cont : A.B. BUILDING CONTRACTING CO.



Project : G+6+ROOF LEVEL – EASY HOTEL AT JAFZA DUBAI
 Consultant : ARCHCORP ARCHITECTURAL ENGINEERING
 Main Cont : KHANSAHEB CIVIL ENGINEERING LLC

Project Gallery for which our system is installed



Project : HARVARD MEDICAL SCHOOL AT D.H.C.C.
 Consultant : ARIF & BINTOAK CONSULTANT ARCHITECTS & ENGINEERS
 Main Cont : AL NABOODAH CONTRACTING LLC



Project : 3B+G+3P+18+GYM FLOOR MAYFAIR RESIDENCY – ON PLOT BB.A06.047
 Consultant : ARAB EXPERT ENGINEERING CONSULTANT
 Main Cont : ENGINEERING CONTRACTING CO LLC

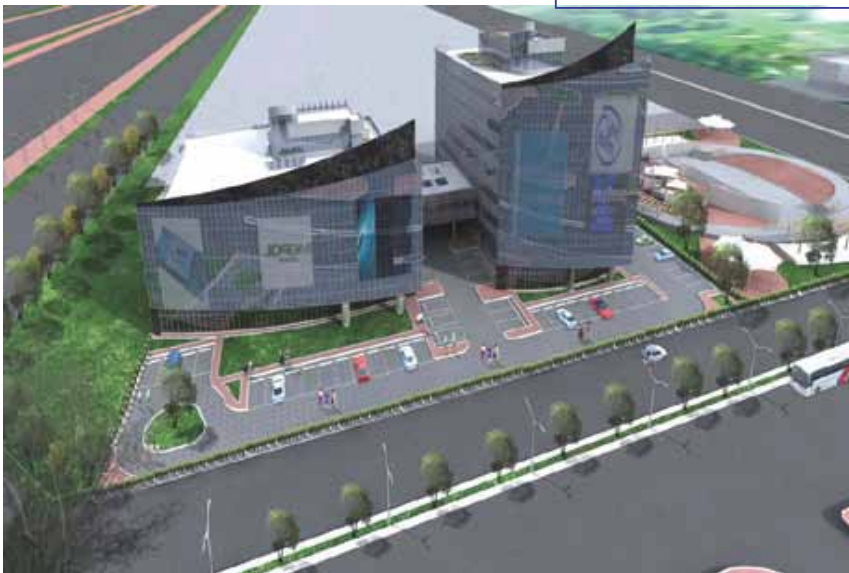

Project : (3B+G+18 FLOOR) IMPZ DUBAI
 Consultant : BDPL GULF ARCHITECTS & CONSULTANT
 Main Cont : AL NEKHREH CONT LLC



Project : B+G+21 FLOOR AL NAHDA FIRST DUBAI
 Consultant : ARKITEKNIK INTERNATIONAL CONSULTING ENGINEERS
 Main Cont : BIN BELAILA CONTRACTING L.L.C

Project Gallery for which our system is installed



Project : 3B+G+9 LEVEL IBIS HOTEL & OFFICES DM.P 124-255
 Consultant : W.S. ATKINS & PARTNERS OVERSEAS
 Main Cont : KHANSAHEB CIVIL ENGINEERING LLC

Project : TRIDENT GRAND RESIDENCE
 Consultant : R.M.J.M ARCHITECHTS
 Main Cont : C.S.H.K Dubai Contracting



Project : IRIS BAY TOWER
 Consultant : W.S.ATKINS & PARTNERS OVERSEAS
 Main Cont : AL HABTOOR ENGG.

Project : 2B+G+29+MECH.FLOOR & 2B+G+1 ON PLOT 392-445
 Consultant : AL HAWRAA ENGINEERING CONSULTANTS
 Main Cont : SHINSUNG ENGINEERING CONSTRUCTION CO LTD